



Sales enquiry at  
**9594991415**



**DEVELOPERS**

**Dipti Associates**

1, Hendre Castle, Gokhale Road (North), Dadar (W), Mumbai- 400 028, India.  
Website: [www.diptigroup.com](http://www.diptigroup.com) | Email: [info@diptigroup.com](mailto:info@diptigroup.com)

**CREDITS**

**RCC Consultants :**

Mr. Dwijen Bhatt Juhu Scheme,  
Mumbai

**Architect :**

Mr. Milind Changani &  
Mrs. Jasleen Changani,  
M/s. B N Shah and Associates,  
Wadala

**Legal Advisor :**

Mr. Shashank Shah,  
M/s. L D Shah & Co.



Approved by MahaRERA, Regn. No. P51900012757 website: <http://maharera.mahaonline.gov.in>

The contents, illustrations, depictions and photographs in this brochure are indicative and for representational purposes only. Information about the project as contained in this brochure is only conceptual and indicative of the kind of development that is proposed and does not constitute part of an offer or contract. Artist's impressions are used to illustrate key features. We do not undertake any misrepresentations implied to any person due to contents of the brochure. We reserve the right to alter, amend, and vary in the interest of the project, the layout, plans, specifications or features subject to the approval of the authorities, without prior notice or obligations. We also reserve the right to modify / revise the specifications and replace the brands mentioned with other comparable brands.

**OPEN UP**  
To An Envious Blend Of  
The Sea & Lush Greens



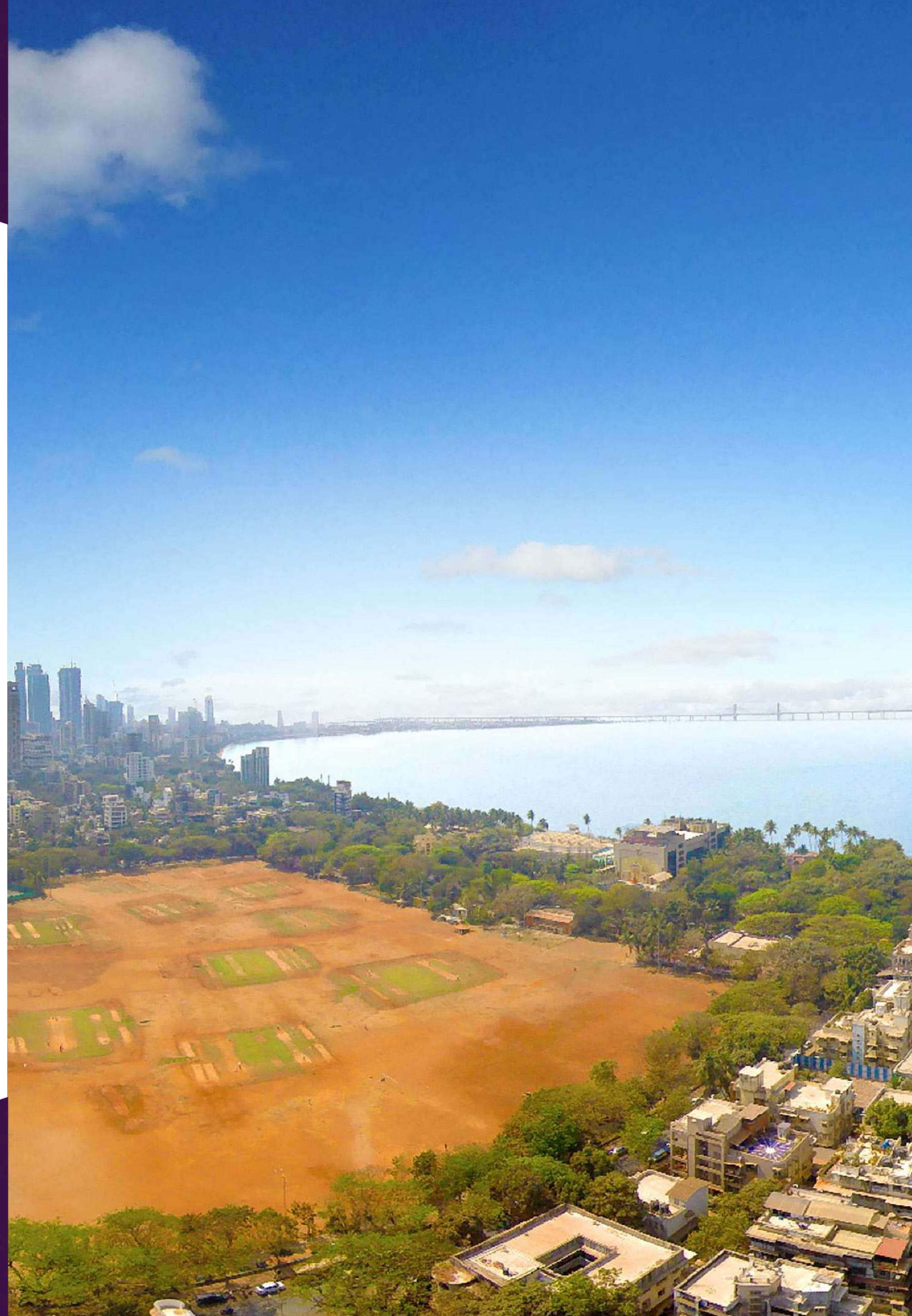
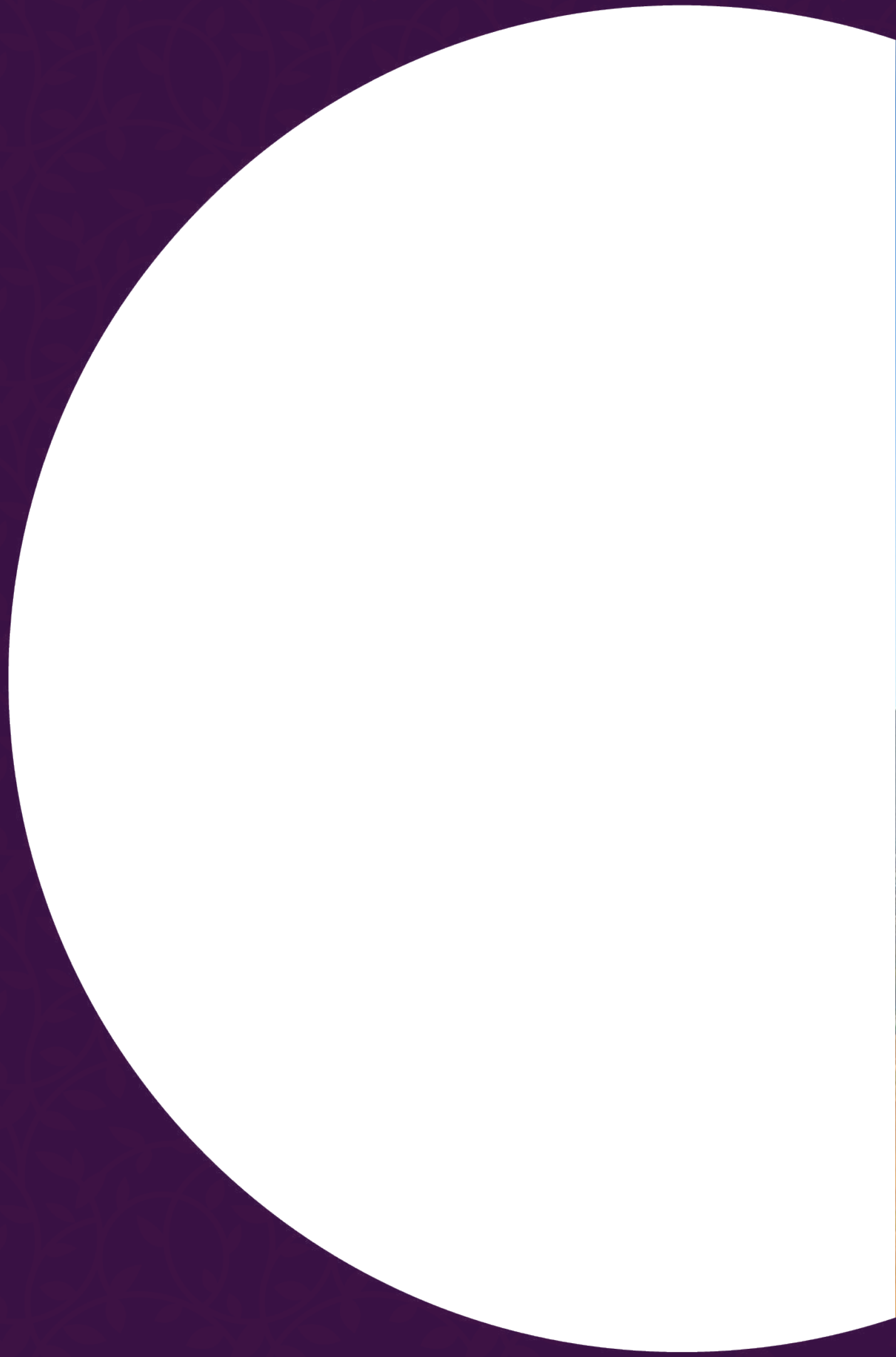





## GET ONBOARD THE ROYAL ARC

The heart of Mumbai, one of the most prestigious residential locations, nestles **The Royal Arc**. At the very heart of the city, yet far above it. There are some who seek a Royal world of their own. For such mavericks, we have designed an abode in the rich peripheries of Dadar West. A location that's brimming with culture, spoilt for choice with the best-in-class amenities and a serene ambience that makes life at **The Royal Arc** simply spectacular.



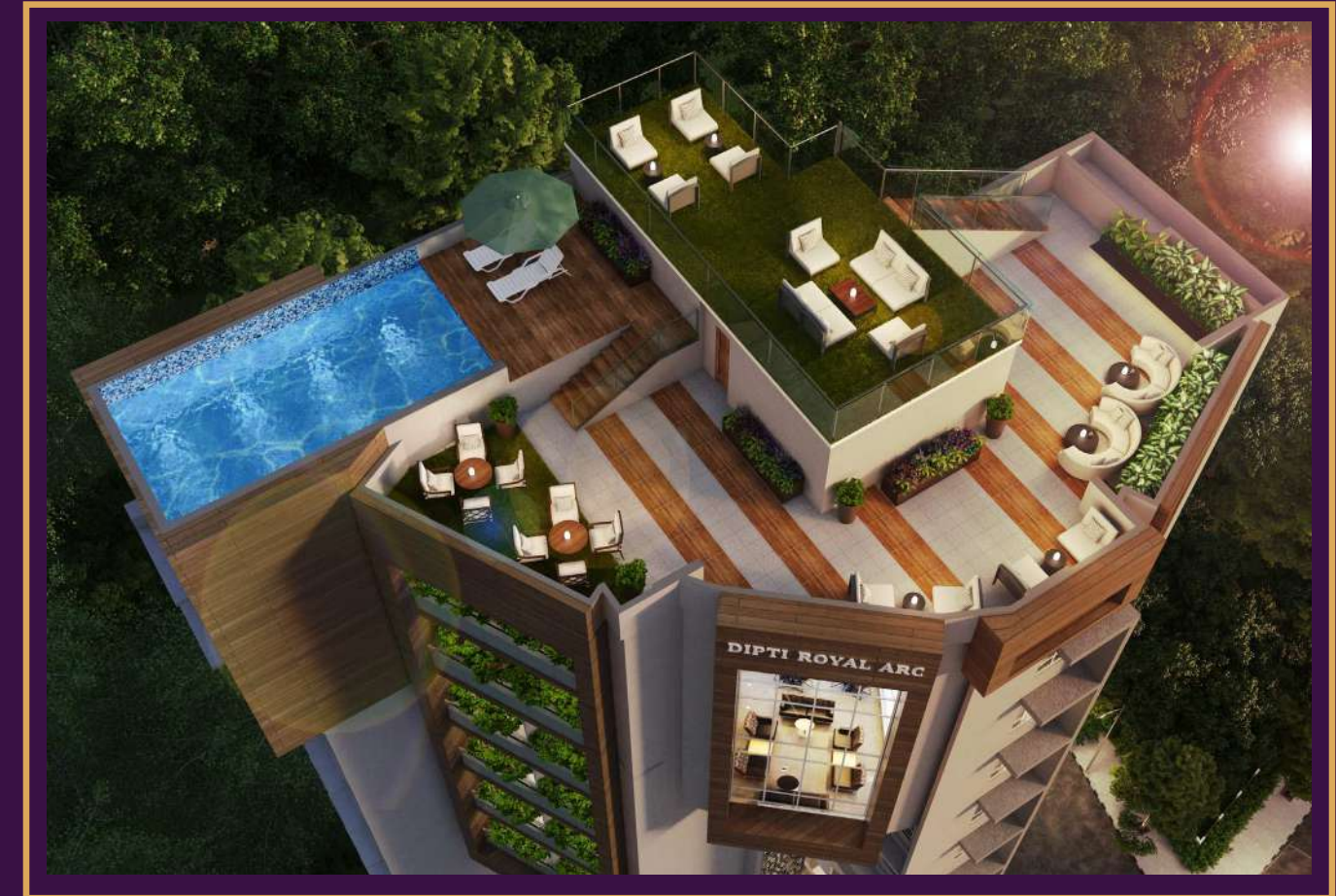

## FOR THOSE WHO'VE BOARDED THE ARC, A ROYAL EXPERIENCE IS AN EVERYDAY AFFAIR

The Royal Arc is a contemporary tower with super-spacious, air-conditioned residences, a rooftop clubhouse with its own pool and a gym with splendid vistas of the city and sea, a panoramic view of Shivaji Park and a lifestyle others can only dream of.

Hold court in the lavish super-sized living room, where the widescreen image on your plasma panel is rivaled only by the sunset view from your open-air deck. The interiors simply live up to the highest tastes in sophistication.



# IT IS THE SMALL THINGS THAT SET US APART



**Architecture in sync with nature**  
Attractive building design with the concept - Tree pods in the air



**The big green scene**  
Select flats with terraces opening towards the greens of Shivaji Park



**Whoever said life's a picnic, had plenty of sports to choose from**  
Wi-fi enabled fitness centre with the latest equipment



**While others dive into the water, you just take the elevator up**  
Proposed rooftop pool



**It's a wonderful whirl, take a dip**  
Jacuzzi



**Live the high life**  
Rooftop garden with Gazebo and sitting area



**Safety first, so it starts right at the enchanting entrance**  
Attractive entrance porch with security cabin



**Security, please!**  
Closed Circuit Cameras (CCTV) for hi-tech digital surveillance



**An entrance worthy of The Royals**  
Grand entrance lobby



**Safety ever, fires never**  
High - Tech fire-fighting system, sprinkler system, fire alarm systems



**When it comes to parking, we're on top of our game**  
Parking tower for swift movement of vehicles with valet service



**Let's save the rain for a rainy day**  
Rainwater Harvesting for recharging groundwater



**Swift lift to the top**  
2 Hi-speed passenger elevators of Otis or equivalent



**When it comes to security, we leave nothing to chance**  
Video door phone with an intercom system for inter-building communication



IT'S NOT JUST A LOCATION ON THE MAP,  
IT'S A LANDMARK

## OTHER PROJECTS



Dipti Square, Jogeshwari (East)



Dipti Ocean Terraces, Shivaji Park



Dipti Surya, Jogeshwari (E)



Dipti Skycity, Ambarnath (East)

### PROJECT ADDRESS:

Plot no. 138, Shivaji Park Road No. 2, Shivaji Park, Dadar (W), Mumbai - 400 028